

- You may photocopy this sheet and use it as an order form.
- Sie können dieses Blatt kopieren und als Bestellformular verwenden.
- Vous pouvez photocopier cette feuille et l'utiliser comme bon de commande.
- Dit blad kan gecopieerd en als bestelformulier gebruikt worden.
- Potete fotocopiare questo foglio e usarlo come modulo di commissione.

## PD-6207 Pedal SHIMANO 600EX

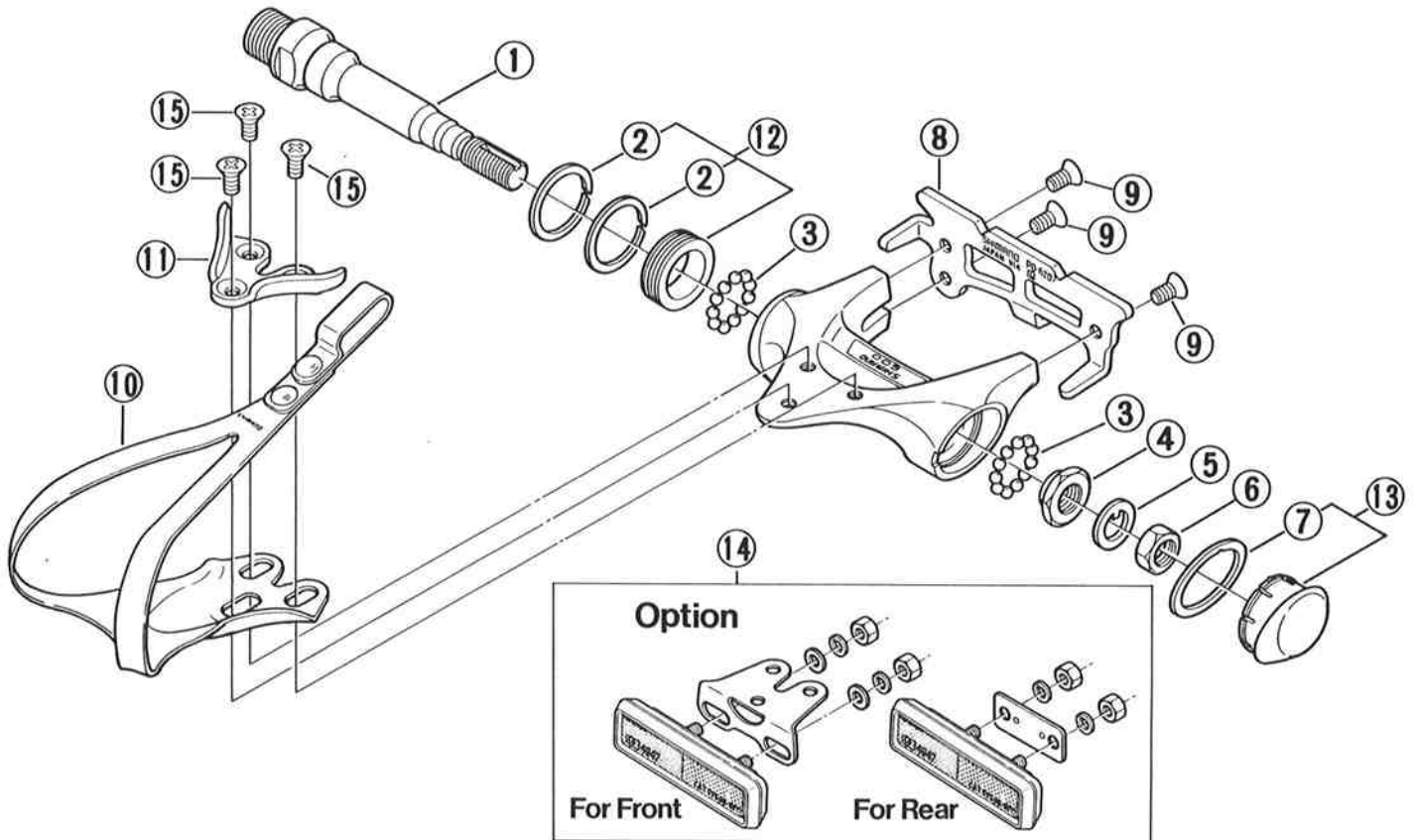

ITEM NO.	PART NO.	DESCRIPTION	Q'TY
1	460 1300	Pedal Axle (Right)	
	460 1310	Pedal Axle (Right) French Thread	
	460 1400	Pedal Axle (Left)	
	460 1410	Pedal Axle (Left) French Thread	
2	460 1900	Seal Ring	
3	000 0151	Steel Ball (5/32")	
4	460 1600	Cone	
5	468 0800	Key Washer	
6	468 0900	Lock Nut	
7	460 2100	Out Side Seal Ring	
8	463 0303-1	Right Side Rear Plate	
	463 0403-1	Left Side Rear Plate	
* 9	000 1902	Plate Fixing Screw (M4x8mm) for Rear Plate	
10	3-461 9801	Toe-Clip M-Size	
	3-461 9802	Toe-Clip L-Size	
	3-461 9803	Toe-Clip LL-Size	
11	440 1120	Front Plate	
12	3-460 9820	Dust Seal & Seal Ring	
13	3-460 9823	Cap & Out Side Seal Ring	
14	3-460 9001	Front & Rear Reflector Unit (Pair) Option	
*15	415 1100	Plate Fixing Screw (M4x10mm) for Front Plate	

**PD-6207** Pedal  
 SHIMANO 600EX

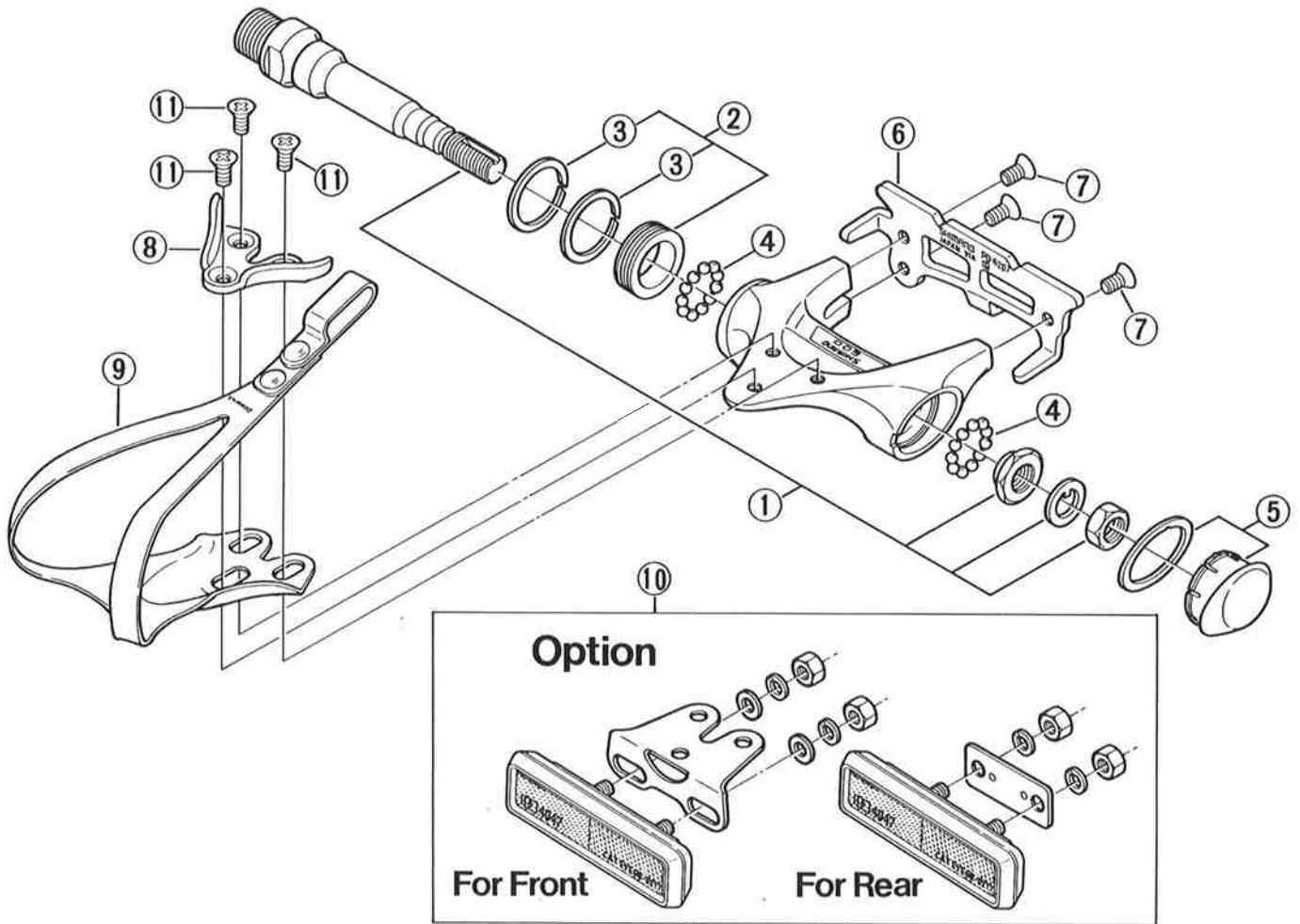

ITEM NO.	PART NO.	DESCRIPTION	Q'TY
1	460 9821	Pedal Axle Unit (Right)	
	460 9822	Pedal Axle Unit (left)	
2	460 9820	Dust Seal & Seal Ring	
3	460 1900	Seal Ring	
4		Steel Ball (5/32") 11pcs.	
5	460 9823	Cap & Out Side Seal Ring	
6	463 0303-1	Right Side Rear Plate	
	463 0403-1	Left Side Rear Plate	
* 7	000 1902	Plate Fixing Screw (M4x8mm) for Rear Plate	
8	440 1120	Front Plate	
9	461 9801	Toe-Clip M-Size	
	461 9802	Toe-Clip L-Size	
	461 9803	Toe-Clip LL-Size	
10	460 9001	Front & Rear Reflector Unit (Pair) Option	
*11	415 1100	Plate Fixing Screw (M4x10mm) for Front Plate	